

## IPS Industry TGP 1.5" RedLine

### Specificatii tehnice

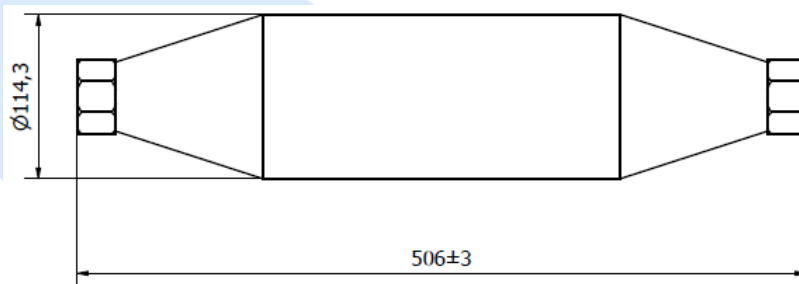

Dimensiuni	
Conexiuni	1.5" (EN 10226)
Lungime	506 mm
Caracteristici tehnice	
Greutate	4.9 kg
Presiune maxima	1 Mpa/10 bar
Debit maxim	8 m <sup>3</sup> /h



### Schema de montaj

Legenda	
<b>A</b>	Instalare pe conducta principala de alimentare cu apa a cladirii (ex: apartament)
<b>B</b>	Instalare pe conducta de apa, cu boiler, fara recircularea apei calde (ex: resedinta familiala)
<b>C</b>	Instalare pe conducta de apa, cu boiler si cu recircularea apei calde (ex: resedinta familiala)
<b>1</b>	Debitmetru apa
<b>2</b>	Vana de inchidere
<b>3</b>	Filtru mecanic
<b>4</b>	Dedurizator galvanic IPS Industry TGP
<b>5</b>	Filtru antimagnetita
<b>6</b>	Pompa de recirculare a apei

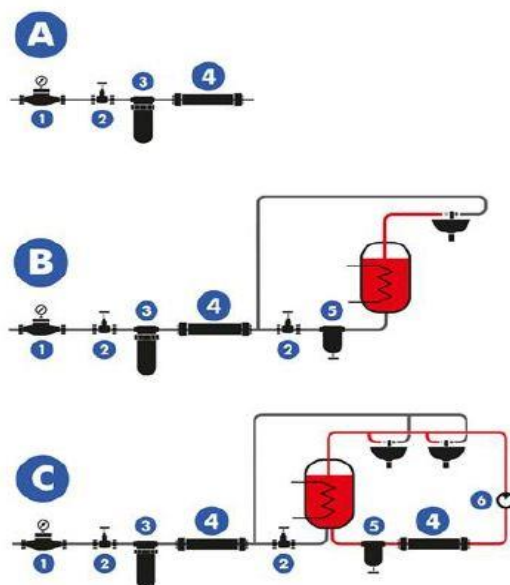

## Cadere de presiune

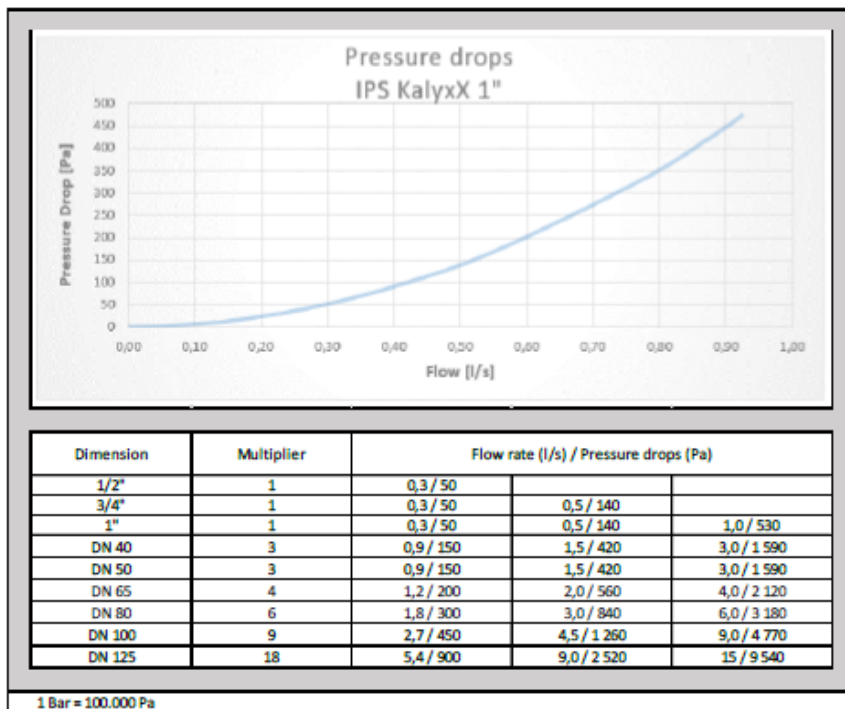

## Debit

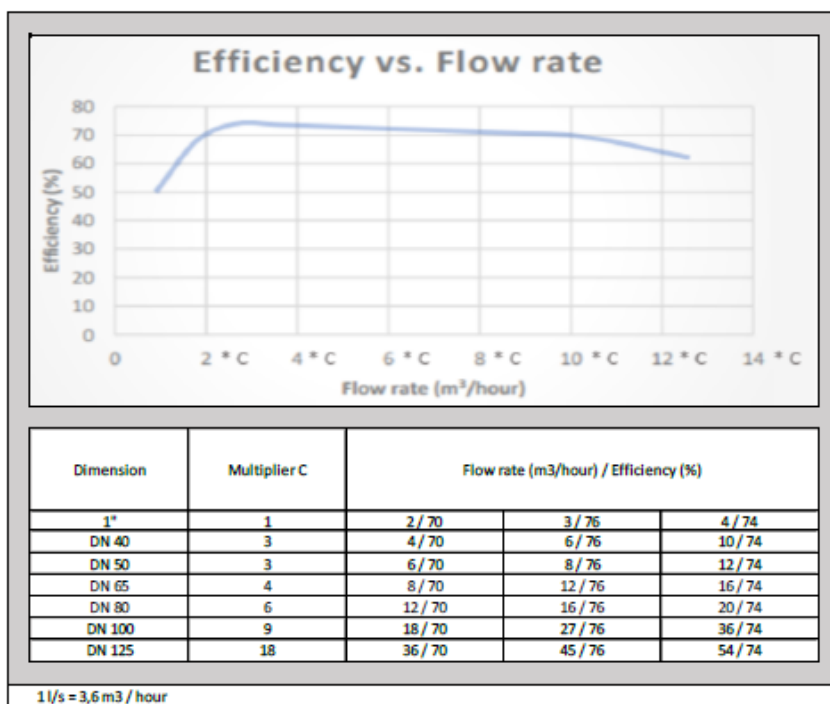

## Timp

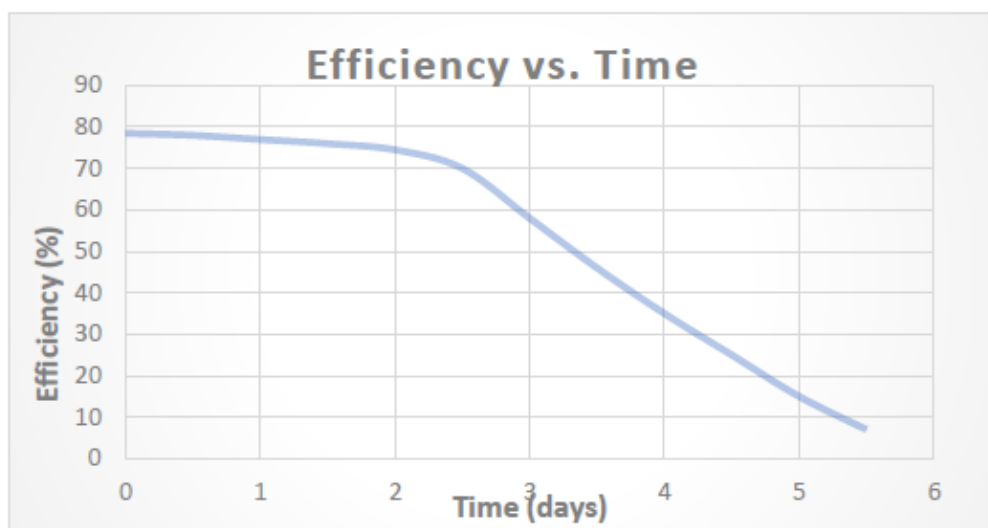

## Temperatura

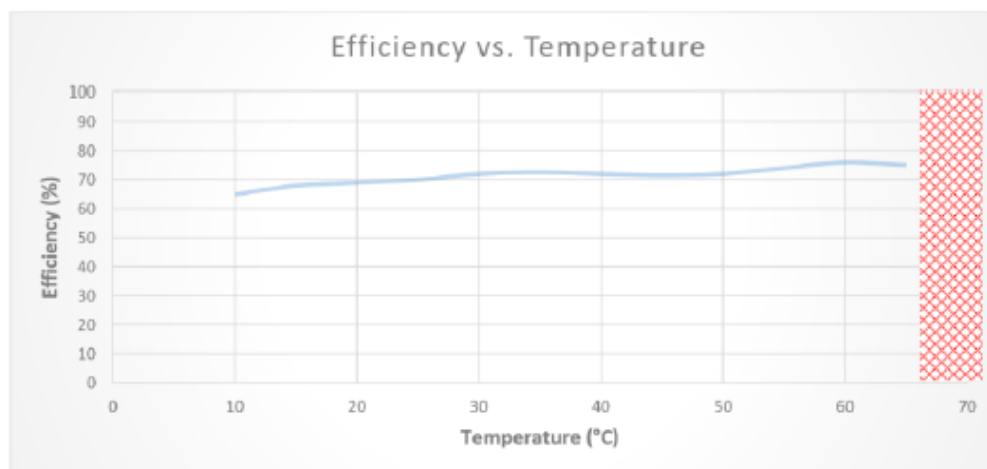

## Instalare



**Atentie:** Respectati sensul de curgere la montajul echipamentului.

